

Propjet polisher Manual

Model PS-01

Ver. N2014-02-15



EN ISO 9001:2008

EN ISO 13485:2012+AC:2012

【 Operating principle 】

The powder jets out from the central pipe of the nozzle to attack tooth stains. Water spray circles the central pipe to wash the teeth and suppress powder fog. The force of attack is determined by the air pressure of dental machinery. The spray is controlled by dental machinery.

【 Scope of application 】

Propjet polisher is mainly used to dental pathology. Biofilm, smoking speck, coffee speck, tea speck can be easily removed. It is also used to polish the teeth.

【 Diagram 】

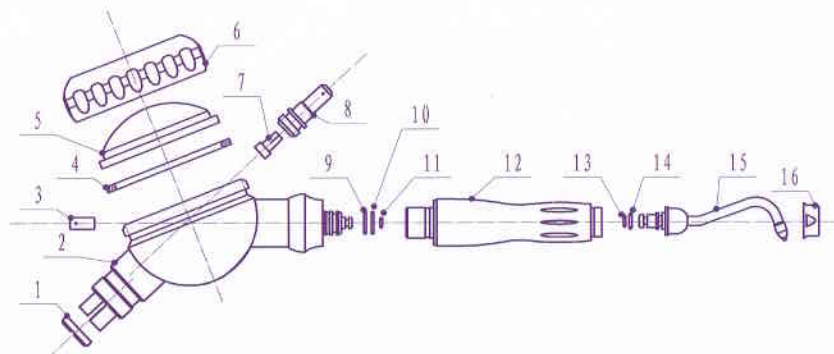

- | | | | |
|------------------------------|--------------------------------|--------------------------------|------------------|
| 1: Gasket | 2: Main body | 3: Powder collector | 4: Gasket |
| 5: Peep pane | 6: Nut | 7: One-way core | 8: One-way shell |
| 9: O-ring $\Phi 5 \times 1$ | 10: O-ring $\Phi 5 \times 1$ | 11: O-ring $\Phi 1.5 \times 1$ | 12: Handpiece |
| 13: O-ring $\Phi 2 \times 1$ | 14: O-ring $\Phi 3.5 \times 1$ | 15: Nozzle | 16: Nut |

【 Features 】

1. Elegant and portable.
2. Put propjet polisher totally or partly in Class B autoclave, or Class S autoclave, or Class N autoclave, 134°C, 0.2MPa.
3. A one-way valve exists to prevent powder from flowing backwards to dental machinery.
4. Removable and rotatable handpiece;
5. Removable and rotatable nozzle.

【 Technical parameters 】

1. The interface is compliant with ISO9168:2009, Third edition, Dentistry-Hose connectors for air driven dental hand piece. Type 2 connector, alias 4 holes.
Or NSK QD-J coupling, alias quick coupling;
2. Water pressure: 0.05Mpa-0.5MPa;
3. Air pressure: 0.2Mpa-0.5MPa;
4. Water flow: $\geq 30\text{ml/min}$;
5. Powder flow: $\geq 3\text{g/min}$;
6. Fit to the powder of sodium bicarbonate or calcium carbonate at 100 mesh;
7. Classification IIa

【 Installation 】

Step1. Pull the lock-loop towards the case as the figure.

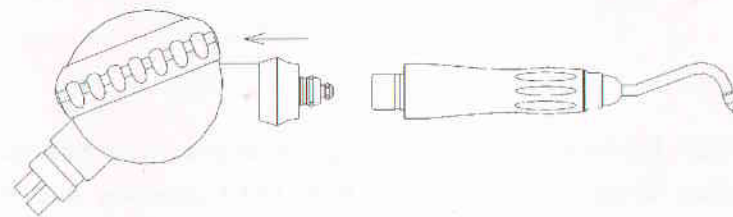

Step 2. Insert handpiece as the figure.

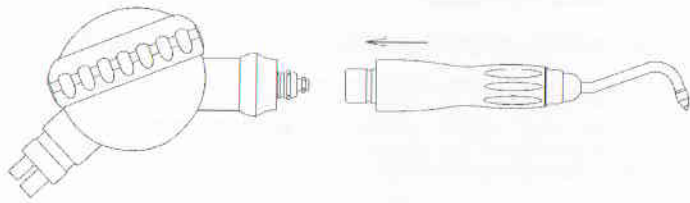

Step3. Release the lock-loop then it will rebound and lock up handpiece.

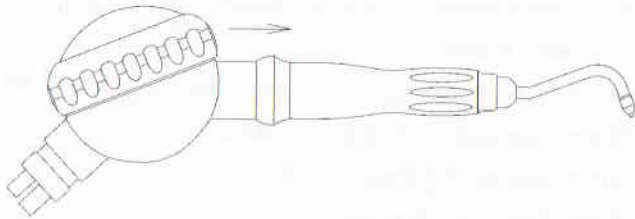

Step4. For NSK QD-J coupling, omit this step, jump to next step.
For 4 hole, Tighten the connector of propjet polisher to the hose of dental machinery.

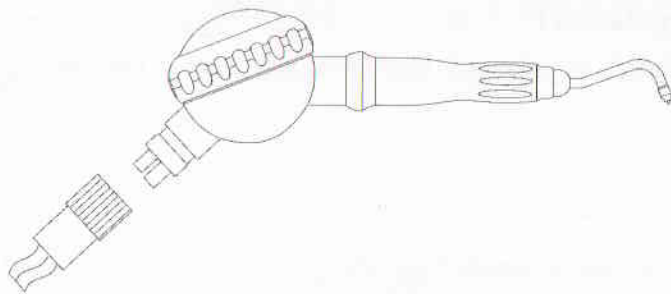

Step5. For NSK QD-J coupling, Tighten the hose to the NSK QD-J coupling firstly, then insert the NSK QD-J coupling into the connector of propjet polisher.



Notes:

1. Make sure that the connector of propjet polisher is connected well to the hose. Tighten gasket between them to separate water from air so that it can avoid water leakage and air leakage, especially avoid water entering the powder passage resulting in powder clogging.

2. The steps of disassembling propjet polisher are in the reverse direction of assembling it.

【 Operation guide 】

Step1. Be sure that the device is on standby.

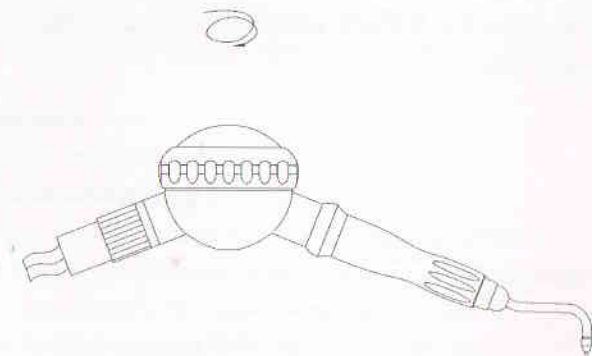

Step 2. Unscrew off the cover

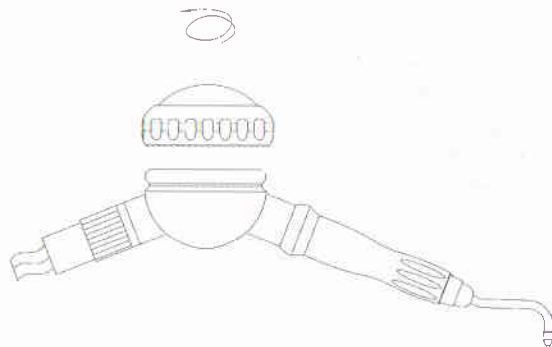

Step3. Pour powder into the case. The level of the powder is lower than the orifices. Don't sink the orifices. 20g is optional.

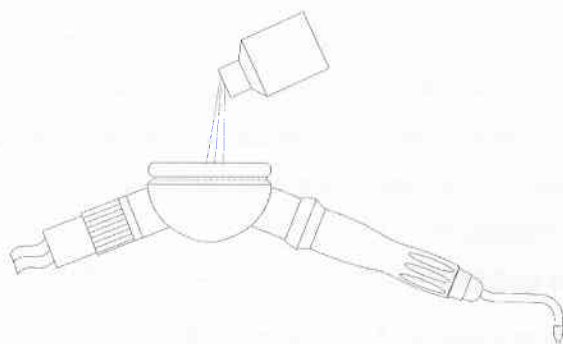

Step4. Put on the cover. Be sure to screw smoothly and thoroughly, then tighten it and check it. Rickety cover is subject to be thrown out, or may cause serious harm.

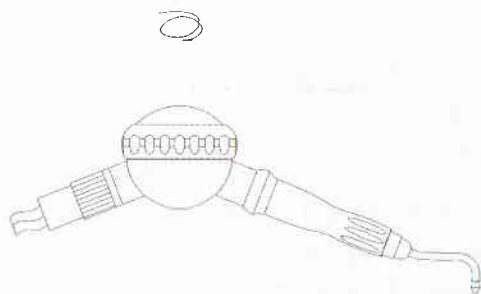

Step 5. Make sure water pressure and air pressure are within the range requested.

It is recommended that the patient and the operator wear eye-protectors.

Step 6. The nozzle aims at the stain at the distance of 1 to 3mm then step on foot switch.

It is advised to move nozzle as small circles, avoid jetting tissues during treatment.

Step 7. During treatment, rotate handpiece to adjust the direction of jet flow

Step 8. Release foot switch, wait a moment till the nozzle stops jetting powder, withdraw propjet polisher.

【 Working Environment 】

Temperature: 10°C-40°C

Relative humidity: ≤70%

【 Maintenance 】

1. After finishing treatment, empty the case, tighten the cover, blow the remaining powder in the passage of jet flow with compressed air to avoid the remaining powder dampening resulting in blocking.

【 Sterilization 】

1. All components can be cleaned by soft cloth with neutral detergent;

2. All components can be sterilized at 134°C, 0.2MPa.

3. Put propjet polisher totally or partly in Class B autoclave, or Class S autoclave, or Class N autoclave, 134°C, 0.2MPa.

【 lifespan 】

The life span is 1 year.

【 Troubleshooting 】

Question 1: How to dredge the powder passage of the nozzle?

Answer: Use a thin needle to dredge the powder passage under water for minutes to dissolve the jam powder.

Question 2: How to solve the clog of the water passage of nozzle?

Answer: Probably, the impurities or bacteria curds in water block the

water passage. Conduct compressed air to one of outlet of nozzle for seconds to blow the impurities or bacteria curds out of the pipe.

Question 3: How to dredge the powder passage of handpiece?

Answer: Use a thin needle to dredge the powder passage under water for minutes to dissolve the jam powder

Question 4: How to solve the clog of the water passage of handpiece?

Answer: The problem is rare, once the problem happens, it is impossible to dredge with needles, because there is one rectangular lane on each end. Try to conduct the compressed air to each end of the handpiece in turn to make the impurities or bacteria curds break down.

Question 5: How to dredge the powder passage of the case?

Answer: Use a thin needle to dredge the powder passage under water for minutes to dissolve the jam powder.

Question 6: How to solve the clog of the water passage of the case?

Answer: The problem is rare, once the problem happens, it is impossible to dredge with needles, because there is one rectangular lane on each end. Try to conduct the compressed air to each end of the handpiece in turn to make the impurities or bacteria curds break down.

Question 7: Why is there the air leakage at cover seal?

Answer: Probably, there is powder on the surface of gasket or the gasket is broken. Clean the gasket or replace the gasket.

Question 8: Why does the propjet polisher just jet water spray, The powder is absent?

Answer: The powder is damp or there is no powder in the case.

Question 9: Why does the propjet polisher just drip water, no jet Flow, no spray?

Answer: The powder passage is clogged. If the nozzle is clogged, refer to Question 1.

If the handpiece is clogged, refer to Question 3. If the Case is clogged, refer to Question 5.

Question 10: Why does not the propjet polisher work efficiently though spray is proper?

Answer: The powder is damp, or the powder is not enough.

【 Caution 】

1. If you intend to preserve propjet polisher for a long time in the future, it is recommended that you maintain it ahead as follow:

Empty the case;

Blow off the remaining powder in the passage to avoid the remaining powder forming curd;

Blow the remaining water in the water passage to avoid the remaining water producing bacteria curd;

Finally, preserve it properly.

2. It is only used by the professional.

3. Propjet polisher fits to the powder of sodium bicarbonate or calcium carbonate. The hard grinding powder is subject to reduce the lifespan of propjet polisher.

【 Contraindication 】

1. Patients who suffer from chronic bronchitis or asthma may not undertake this treatment because air and dust may induce them hard breath.

2. Patients who are limited to intake salt must not undertake the treatment, since the basic ingredient of powder is sodium bicarbonate which contains certain salt.

【 Package and accessory 】

1. Propjet Polisher: 1

2. Bottled powder: 1

(The powder may be absent, it depends on the shipping laws of the country)

3. Dredging needle: 1

4. Operation manual: 1

5. Acceptance certificate: 1

6. Peep pane: 1

7. Φ 5x1 O-ring: 2

8. Φ 3.5x1 O-ring: 1

9. Φ 2x1 O-ring: 1

- 10. Φ 1.5x1 O-ring: 1
- 11. Φ 43x Φ 37x2 O-ring: 1

【Storage】

The packaged product should be stored in draughty and dry place without corrosive gas.

Humidity: \leq 93%

Temperature: -40 $^{\circ}$ C-55 $^{\circ}$ C.

【Symbol】



Symbol for "MANUFACTURER"



Symbol for "AUTHORISED REPRESENTATIVE IN EUROPEAN COMMUNITY"



Symbol for "NON-STERILE"



Symbol for "CAUTION"

【Waste disposal】

The box is carton.

Underlay in the carton is EVA foam which comply with environment protection.

Propjet polisher is made of Aluminum , Brass ,Stainless steel and plastic.

There is not any dangerous material.

【Guaranty】

Please keep the "Guaranty Form" carefully in case of after-sale service. The service owing to the quality in the first year is free of charge.

Model	PS-01	Date	
Dealer		Consumer	
Address			
Maintain Record			
Date	Item	Repairer	Remark