

# Adper™ Single Bond *Plus*

## Adhesive



## Nanofiller Technology for Higher Bond Strengths

### Summary of advantages

- Excellent bonding to dentin and enamel
- Doesn't need shaking; nanofiller is stable and will not settle
- Convenient bottle design allows easy opening and dispensing
- Available in disposable Unit Dose delivery
- Reduces the risk of post-operative sensitivity

### Indications

- Direct restorations
- Indirect restorations after light curing\*\*
- Root surface desensitization
- Veneers\*

**The use of innovative nanofiller technology contributes to higher performance and confidence.** Adper™ Single Bond *Plus* total-etch adhesive is based on the clinically-proven Adper™ Single Bond Adhesive. As with the original Adper Single Bond adhesive, it contains the moisture-tolerant Vitrebond™ copolymer in a water/ethanol solvent. And, because it is ethanol-based, it won't evaporate on the tooth.

This adhesive also contains a highly-dispersed bonded nanofiller – similar to that first used in Filtek™ Supreme Universal Restorative – which contributes to even higher performance. And the low film thickness makes it ideal for use on veneers\*, inlays and onlays.

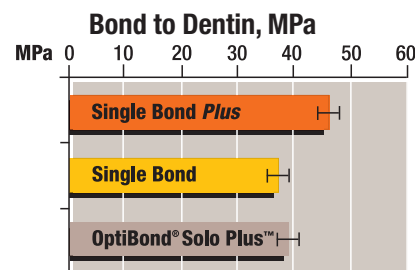

**Microtensile bond evaluation shows significant improvement in dentin bond strength.**

Source: Dr. Jorge Perdigao, University of Minnesota

### Proven in long-term clinical studies.

Adper Single Bond *Plus* is based on the clinically proven chemistry of the original Adper Single Bond dental adhesive. Long-term clinical studies on Adper Single Bond adhesive include:

**Clinical evaluation of CAD/CAM generated composite inlays: Six year report.**

Internal report to 3M ESPE 2006  
Fasbinder DJ, Dennison JB, Heys D, Lampe K.

**Filtek™ P60 – One year results.**

Internal report to 3M ESPE 2002; Perry R, Kugel G, Papathanasiou A, Bardwell D.

**Report on three year qualitative and quantitative evaluation of the clinical performance of Z100™ and Filtek™ Supreme posterior resin composites.**

Internal report to 3M ESPE 2007; Lambrechts P, Van Meerbeek B, Peumans M, Palaniappan S.

**CEREC® milled Paradigm™ MZ100 for extensive restorations.**

Internal report to 3M ESPE 2004; Prevost A, Fortin D.

**Filtek Supreme three year clinical results**

Internal report to 3M ESPE 2005; Suzuki M, Stockton LW, Davidson DF.

**Clinical evaluation of Filtek™ Z250 as a posterior restorative material**

Internal report to 3M ESPE 2004; Suzuki M, Stockton LW, Davidson DF.



\*With 3M™ ESPE™ RelyX™ Ceramic Primer and 3M™ ESPE™ RelyX™ Veneer Cement  
\*\*When combined with 3M™ ESPE™ RelyX™ ARC Adhesive Resin Cement



**Get assurance of consistency in every drop.**

Adper™ Single Bond *Plus* Adhesive contains a highly-dispersed bonded nanofiller which does not allow particles to cluster together. The particles are stable and will not settle out of dispersion. So unlike some filled adhesives, Adper Single Bond *Plus* adhesive does not require shaking prior to use.

Dentists can have total confidence the adhesive is perfectly mixed every time.

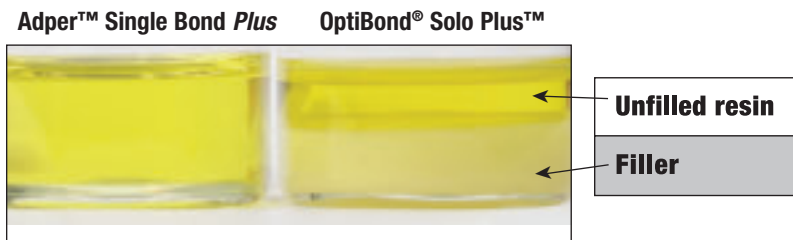

Adper™ Single Bond *Plus* Adhesive dispenses perfectly mixed from the vial every time ...  
**NO SHAKING REQUIRED!**

Source: 3M ESPE Laboratory test data

**The unit dose delivery option is convenient and easy to use.**

Adper Single Bond *Plus* Adhesive is now available in a unit dose delivery option. There's no measuring, mixing or cleanup. The unique design is self-contained – holding the adhesive and brush-tip applicator.

Plus, the unit dose offers hygienic dispensing since it's completely disposable.

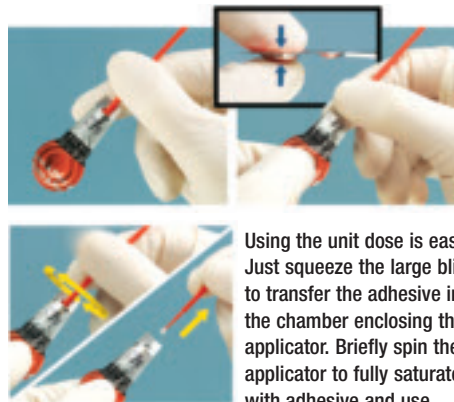

Using the unit dose is easy. Just squeeze the large blister to transfer the adhesive into the chamber enclosing the applicator. Briefly spin the applicator to fully saturate with adhesive and use.

**Ordering Information**



**3M™ ESPE™ Adper™ Single Bond *Plus* Intro Kit**



**3M™ ESPE™ Adper™ Single Bond *Plus* Unit Dose Kit**

Item Number	Product Information
51101	<b>Adper™ Single Bond <i>Plus</i> Intro Kit<sup>1</sup> (vial)</b> Kit includes: 1 vial – 6g adhesive <sup>2</sup> ; 2 – 3ml etchant syringes <sup>2</sup> ; mixing wells <sup>2</sup> ; brush handle <sup>2</sup> and brush tips <sup>2</sup>
51102	<b>Adper™ Single Bond <i>Plus</i> Refill<sup>1</sup></b> 1 Adper vial – 6g adhesive
51000	<b>Adper™ Single Bond <i>Plus</i> Unit Dose Kit<sup>1</sup> (40)</b> Kit includes: 40 Unit Dose applicators <sup>2</sup> ; 1 – 3ml etchant syringe <sup>2</sup>
51001	<b>Adper™ Single Bond <i>Plus</i> Unit Dose Kit<sup>1</sup> (100)</b> Kit includes: 100 Unit Dose applicators <sup>2</sup> ; 1 – 3ml etchant syringe <sup>2</sup>

<sup>1</sup> MSDS available. Call 1-800-634-2249    <sup>2</sup> Also available separately

**Customer Care Center 1-800-634-2249    www.3MESPE.com**

**3M ESPE**

**Dental Products**  
3M Center  
Building 275-2SE-03  
St. Paul, MN 55144-1000  
U.S.A.  
1-800-634-2249

**3M Canada**  
Post Office Box 5757  
London, Ontario N6A 4T1  
Canada  
1-888-363-3685

Please recycle. Printed in U.S.A.  
© 3M 2007. All rights reserved.  
70-2009-3686-5

3M, ESPE, Adper, Filtek, Paradigm, RelyX, Vitrebond and Z100 are trademarks of 3M or 3M ESPE AG. Used under license in Canada. CEREC and OptiBond Solo Plus are not trademarks of 3M.